

# CKFD14 FORD CYCLONE 3.5



Kit per applicazione di farfalle singole coniche su motori Ford Cyclone 3500 cc V6 composto di 6 corpi farfallati SF45/0/1, collettore di aspirazione, flauto benzina, leveraggi completi e di 6 trombette curve. Utilizzato per elaborazioni di tipo kit car, è stato progettato per uso competizioni, ma adattabile in tutti gli utilizzi, garantisce un'ottimizzazione dell'aspirazione e del riempimento della camera di combustione aumentando così la potenza del motore. Per motori Ford 3500 V6 Cyclone, rimane sotto il cofano anche alloggiato sulla Ginetta G50.



Ford Cyclone 3.5 V6 ITB throttle body kit from Jenvey Dynamics includes six SF45/0/1 throttle bodies with an operating wheel linkage, two crossover EFI inlet manifolds, two fuel rails and six curved airhorns. Jenvey throttle bodies and all Jenvey throttle body accessories are engineered for Motorsport, offering excellent performance, reliability, lightness and value. This kit is ideal for road, track or rally use. The engine is used widely in the US and this kit will fit under the bonnet of a Ginetta G50. Made to order - up to 2 weeks to dispatch.

**JENVEY**

MF14 - Ford Cyclone V6 manifolds for individual throttle bodies

© Jenvey Dynamics Ltd 2000-2010  
Issue 2  
www.jenvey.co.uk

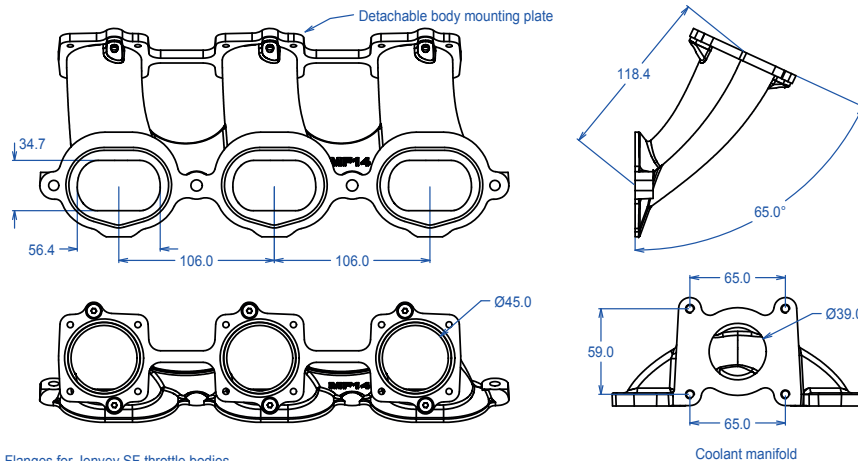

Flanges for Jenvey SF throttle bodies.  
O ring seal to cylinder head.  
Supplied as matched pair which intertwine for cross-over induction.  
Comes with coolant manifold and all necessary O rings and assembly bolts.  
Bosses on top side for vacuum tapplings.

