

CKMZ03 MAZDA MX5 1.6



Kit di corpi farfallati doppi della Jenvey che completo di collettore, flauto benzina e trombette lunghe 40 mm permette di montare sui motori Mazda MX5 (Miata, Eunos) 1.6 It consentendo così' dopo adeguata rimappatura della centralina, di ottenere buoni incrementi di potenza. Il Kit Jenvey, nato per utilizzi nell'ambito del Motorsport, e adattabile anche per altri utilizzi, mantiene infatti intatte le sue capacità di incrementare la potenza per i motori 1600cc Mk1 e Mk2 utilizzati su Mazda MX5, Miata e Eunos.



Mazda MX5 (Miata, Eunos) 1.6 ITB throttle body kit from Jenvey includes a pair of twin TB42mm throttle bodies, an EFI inlet manifold, fuel rail and 40mm long airhorns. Jenvey throttle bodies and all Jenvey throttle body accessories are engineered for Motorsport, offering excellent performance, reliability, lightness and value. This kit is ideal for road, track or rally use and fits the Mk1 and Mk2 1600 engine in the Mazda MX5, Miata and Eunos.

JENVEY

MMZ03 - Mazda MX5 1.6L manifold for twin throttle bodies

© Jenvey Dynamics Ltd 2000-2012
Issue 1
www.jenvey.co.uk

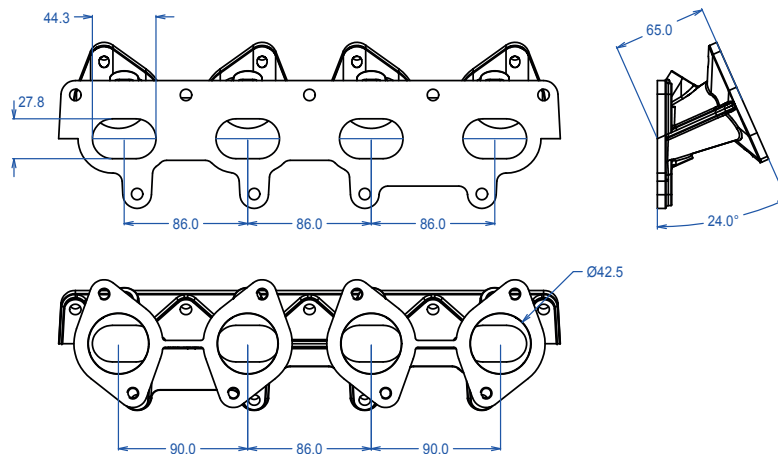

May be ported up to 46mm at body flange and proportionally at head flange.
Undrilled bosses on top side for injector ports, vacuum tappings etc. and undrilled bosses on underside for vacuum tappings.

